

1 – Make a hole of the corresponding dimensions (check hole size in the catalogue) in the wall.

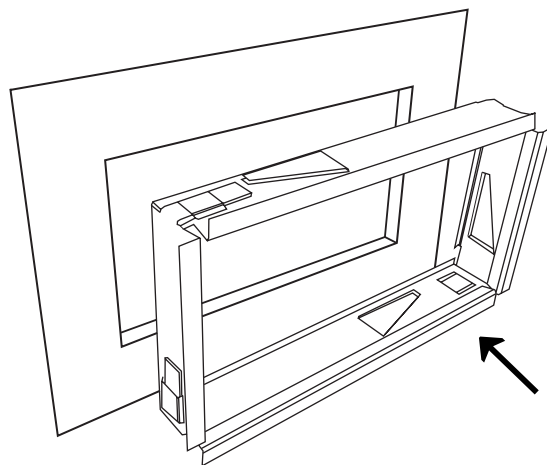

2 – Place the mounting frame into the hole, pressing it firmly against the wall.

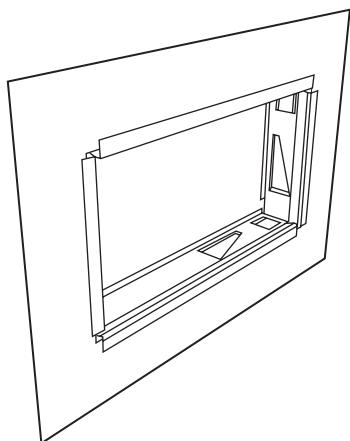

3 – Press the frame against the wall until it is positioned as shown in the image, and secure it by bending the tabs.

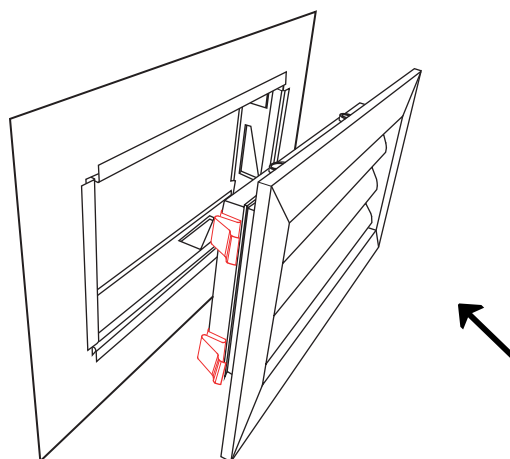

4 – Push the grille with the springs against the mounting frame until it clicks.

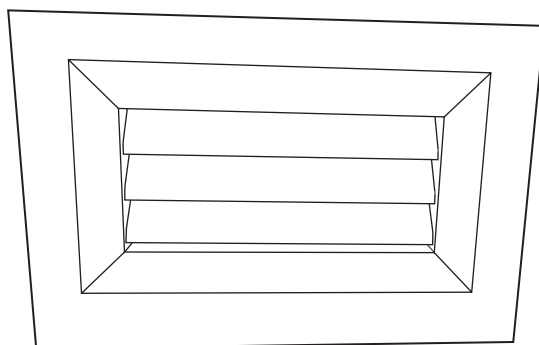

5 – The springs exert pressure against the frame, securely fixing the grille.

For spring fixation, an alternative to the mounting frame is E-CLIPO. The grille installation follows the same steps, only changing steps 2 and 3:

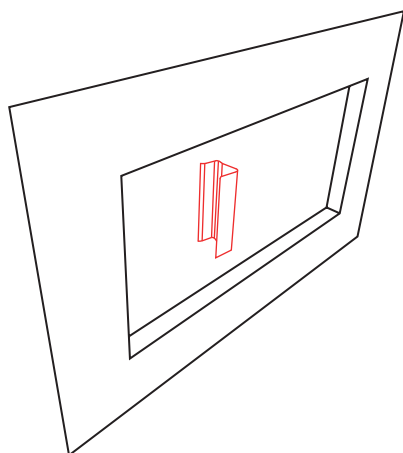

2' – Place the E-CLIPO, accounting for the wall thickness (13 mm or 15 mm).

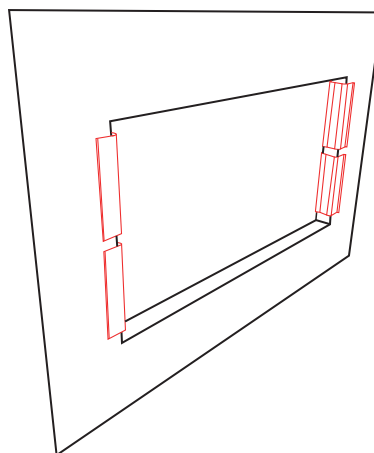

3' – Position the E-CLIPO approximately where the springs will be located.